

FOR SALE

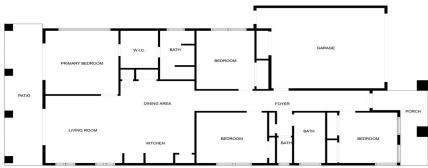

14 Ferntree Drive, Werribee

While every attempt has been made to ensure the accuracy of the floor plan contained here, images are not to scale, and are for illustrative purposes only and should be used as such by any prospective purchaser. The services, systems and appliances shown have not been tested and no guarantee as to their operability or efficiency can be given.

RE/MAX ACPA



14 Ferntree Drive, Werribee

Nestled in the heart of Werribee, 14 Ferntree Drive presents an exceptional opportunity for families seeking contemporary comfort in a serene suburban setting. This modern residence offers an ideal fusion of style, space, and functionality, providing a sanctuary you'll be proud to call home.

Highlighted by:

- * Wetland facing
- * 561 m² big land
- * Master bedroom with a walk-in robe and ensuite
- * Remaining bedrooms feature built-in robes, providing ample storage
- * Open-plan design seamlessly integrating kitchen, meals, and living areas
- * Well-equipped kitchen with stainless steel appliances
- * Ducted heating ensuring a cozy atmosphere year-round
- * Evaporative cooling *
- * Double remote garage for secure parking
- * Low maintenance front and rear yards, perfect for easy upkeep

Conveniently located amenities include:

- * Close proximity to schools
- * Few-minute drive to Pacific Werribee Shopping Centre
- * Moments away from River Walk Village Park
- * Easy freeway access to both Melbourne CBD & Geelong

Indulge in the modern comforts and endless convenience that this exceptional residence has to offer. Contact our agents now at rentalacpa@remax.com.au to enquire further about this



Price: Contact Agents

Inspect: 25-05-2024 10:30 AM - 11:00 AM

View: [remax.com.au/property-details/R2-4047649](https://www.remax.com.au/property-details/R2-4047649)

Leon Lee

M 0450 681 019

Yisa Weng

M 04 2650 5287

RE/MAX ACPA, Williams Landing

<http://www.remaxacpa.com.au/>

Each office independently owned and operated

Williams Landing, VIC, 3027

OFFICE 03 9958 9825